

cortina pellet



A modern automatic boiler that effectively burns all types of wood pellets

The Cortina Pellet boiler is equipped with an innovative pellet combustion system the basis of which constitute a differential pressure sensor and optical fuel level sensors on the grate, which, together with a unique algorithm of operation, form a pioneering, unique on the market, intelligent combustion control system that automatically adjusts the combustion process according to granulation and the chemical composition of the fuel. This system, at any fuel change, automatically adjusts all combustion parameters without the need to weigh the pellets and make manual adjustments to the settings in the controller.

Additional sensors are part of the safety subsystem which, by controlling deviations of the differential pressure parameters, inform about obstructions in the boiler flue gas ducts, preventing potential dangerous situations.



wood pellet
A1, A2, B



automatic
ignition



automatic
cleaning



modern
RTJ burner





adjustment
of the combustion
process



heat-resistant
ceramics

Technical data

 available heating power range	kW	14 21 28		
 power modulation range	kW	4-14	7-21	9-28
 approximate heating area*	m ²	40-140	70-210	90-280

thermal efficiency reaching up to:

< 95%

nominal power kW	thermal efficiency %	energetic efficiency class	water capacity dm ³	tank capacity dm ³	flue gas outake diameter mm	boiler weight kg
14	94.1	A+	45	150	145	340
21	94.5	A+	45	150	145	340
28	94.9	A+	45	150	145	340

Controller

ST-912 zPID



Control: igniter control, feeder control, cleaning grate control, fan control, central heating and domestic hot water pumps control and two auxiliary pump control, liquid control with mixing valve, weather control of valve, weekly control.

Functions: showing the amount of fuel in the tank, software update via USB, possibility to connect two additional valve control modules (e.g. ST-61 or EU-431n), cooperation with a room regulator, buffer service.



touchpad



smooth power modulation



intelligent zPID algorithm



remote control option **

* The given areas of the heated facility are only approximate

** On condition that an additional ST-505 or WiFi RS module is connected

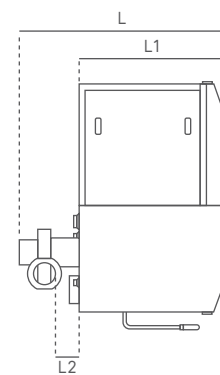
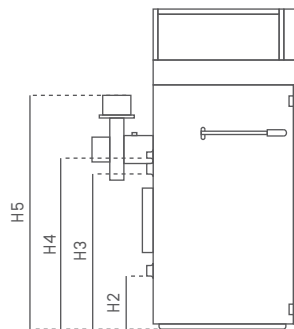
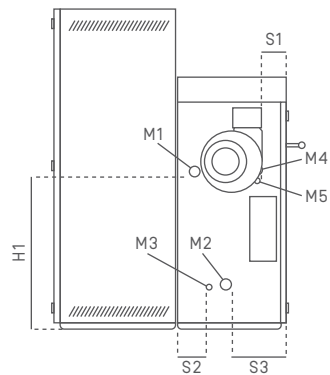
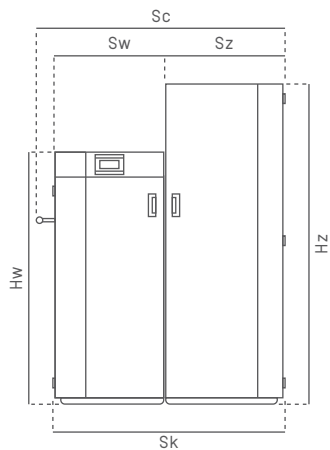

	power	Sc	Sk	Sw	Sz	S1	S2	S3	Hz	Hw	H1	H2	H3	H4	H5	L	L1	L2
	kW	mm	mm	mm	mm	mm	mm	mm	mm	mm	mm	mm	mm	mm	mm	mm	mm	mm
	14	1290	1210	570	640	144	150	290	1640	1290	780	210	750	817	1130	1065	760	110
	21	1290	1210	570	640	144	150	290	1640	1290	780	210	750	817	1130	1065	760	110
	28	1290	1210	570	640	144	150	290	1640	1290	780	210	750	817	1130	1065	760	110

	muff	M1	M2	M3	M4	M5
diameter		6/4"	6/4"	1/2"	1/2"	3/4"
intended use		boiler outlet	boiler inlet	drain valve	safety valve	cooling valve

Reference cross-section

